

## Technical Information

**TAKE INTO CONSIDERATION THAT THE AUDIENCE SITS IN FRONT AS WELL AS ON THE SIDES OF THE STAGE. GOOD TO KNOW FOR YOUR CHOREOGRAPHY.**

There is a staircase to get to the stage level

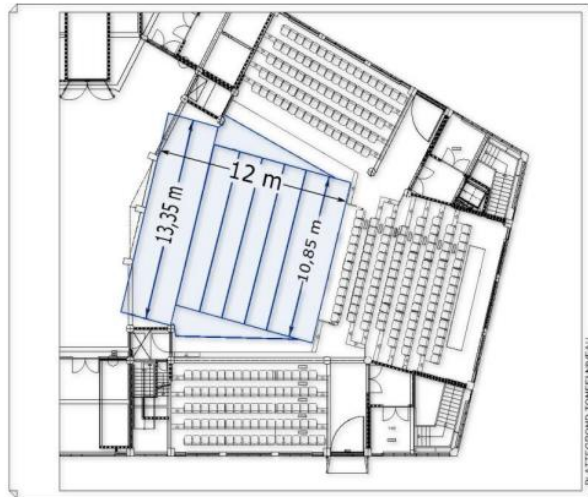

Width front stage: 10.85 m - Width rear stage: 12.35 m

Maximum depth of the dancing space floor 10.00 m

Free height: 6.50 m - Free height at the bottom of side bridges: 5.20 m

The stage will have 1 coulisse (wings) on each side.

On both days there's a short time allocated for some spacing on stage. Our stage manager and assistant stage manager will check the timing (on a first come, first serve basis) so that dancers can do only spacing (no run-throughs or rehearsals with music allowed).

VERY IMPORTANT: competitors will **ENTER STAGE RIGHT** and **EXIT STAGE LEFT**. Returning to the dressing room or foyer is mandatory after your performance. You may not hang out backstage. (members of the team will be there to guide you from the dressing room to the backstage area).

Please if you use any PROPS make sure to enter this important information on our registration form online.

NB: Strictly NO water, slime, glitter, paint, or talcum powder or any other slippery things are allowed on stage.

We provide ROSIN (*pece* in Italian) backstage for the dancers who perform on pointe.

